

Thomas Homes & R.V. Center Inc

Show Home #5

2022 SWII-234 20x76
1,520 Sq. Ft – 3 Bed/2 Bath

**Includes 1 Year of Free Homeowners Insurance/ Includes Free Delivery within 300 Kilometers
Home Meets/Exceeds the New “Alberta Building Codes” for Zone 7B**

Exterior Colours:

- Vinyl siding- Colour: Storm
- 30 years Fiberglass Shingles: Dual Brown
- Coloured Metal Fascia: Antique Brown
- Exterior Trim: Heritage Brown
- Exterior Accent Package: Included Smart Start Corner, Smart Start Borders (B), & Eura Pillars
- 20' Gable with Upgraded Accent Color: Majestic Brick
- Beach House Vinyl Shakes in Front Gable & Hitch End: Pacifica

Interior Colours:

- Wall Colour: Heather Champagne
- Flooring: Upgraded Lino: Walnut T/O
- Cabinets: V-Groove Smokewood
- Upgraded Countertop: Portoro

Added Options:

- S/S Appliances: 19Cu. Ft. Fridge with Bottom Freezer, Ceran Stove Top Range, Rangehood and Dishwasher.
- 3 Door Island with Extended Eating Bar
- Buffet & Hutch
- Soft Close Doors & Drawers with Upgraded Cabinet Handles
- Crown Molding Kitchen Uppers
- Ceiling Insulation to R40, Upgraded Floor Insulation to R48, Upgraded Wall Insulation to R22
- Utility Passage Door-Open above (no grill)
- 7B Zoning Requirements: HRV System with Upgraded North Zone Vertical Siding Windows Through Out
- 50 USG Conv Gas Hot Water Tank
- Oval Tub in Ensuite
- A/C Ready Split System Incl: Subbase Thermostat, 18/5 Wire, 30 Amp Breaker, Coil Cabinet in Furnace, Junction Box & Appropriate Wiring, 2 Speed Low Noise Furnace

Thomas Homes & R.V. Center

Box 7020 9900-78ST Peace River, AB

www.thomashomesandriv.com PH# 780-624-2720

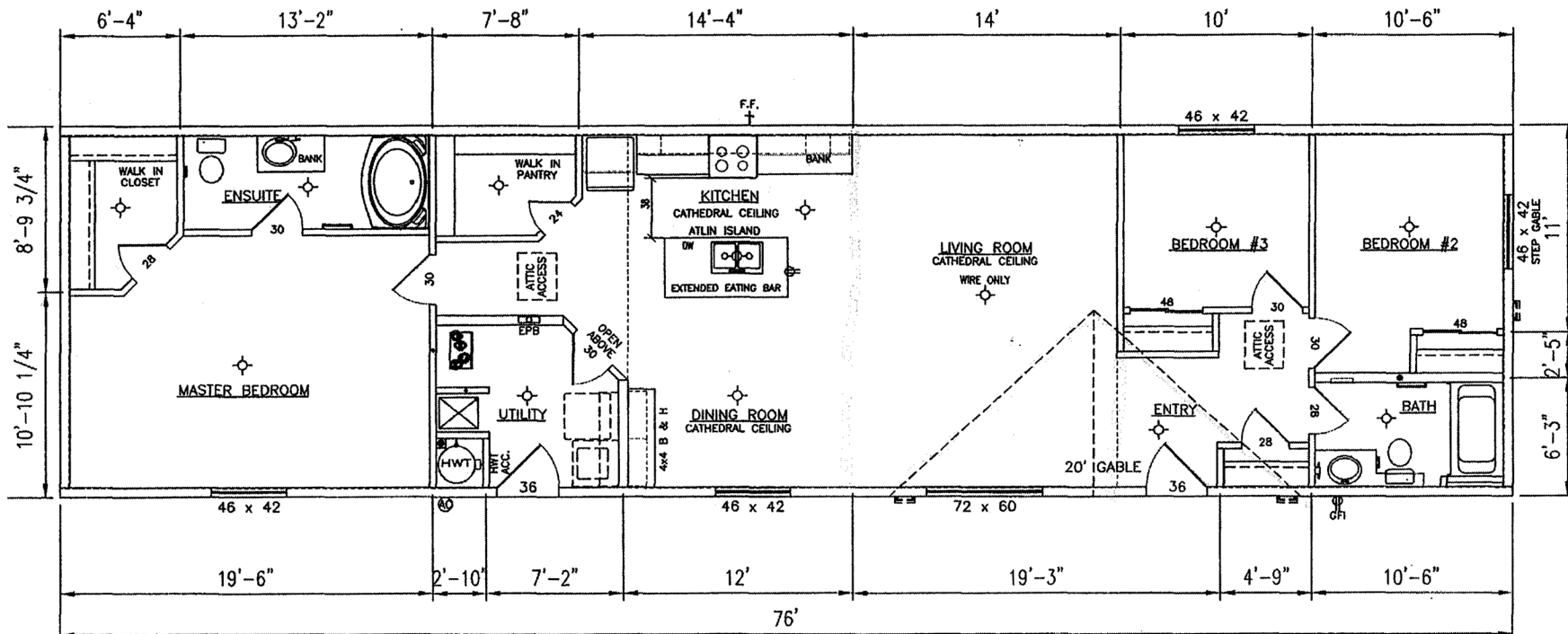

Show Home #5 SWII-234

2022 20x76 1520 Sq. Ft 3 Bed/2 Bath

