

Thomas Homes & R.V. Center Inc

Show Home #2

2022 CJS 3009 20x52
1,040 Sq. Ft – 2 Bed/2 Bath

**Includes 1 Year of Free Homeowners Insurance/ Includes Free Delivery within 300 Kilometers
Home Meets/Exceeds the New "Alberta Building Codes" for Zone 7B**

Exterior Colours:

- Marine Dusk with Beach House Shakes-Hatteras
- 4" Smart Start Windows & Doors, Corners, Charcoal with Knee Braces in Hitch End Gable-Charcoal
- 30 years Fiberglass Shingles: Dual Grey
- Coloured Metal Fascia: Slate

Interior Colours:

- Wall Colour: Pumice White
- Flooring: Lino Colour 9591
- Cabinets: White PVC V-Groove Cabinets

Added Options:

- Upgraded Appliances: S/S 33" Side by Side with Water, S/S Electric Ceran Cook Top, S/S Dishwasher and Cabinet Style Rangehood-White
- Atlin Island with Extended Eating-Sink & Dishwasher in Island
- Crown Mouldings Over Upper Kitchen Cabinets
- Soft Close Hinges and Drawers, Upgraded Pull Handles
- Full Tile Backsplash in Kitchen-White 3x6 Subway Tile
- Set of Five Pot Lights in Kitchen with Two Pendant Lights Above Island
- Upgraded Laminate Countertop: Italian White Di Pesco
- 42" Electric Fireplace with Wall Mount TV PKG with Wood Barn Board Feature Wall-Grey-ish
- Ceiling Fan in Living Room
- Decora Switch Package & 3-Way Switch at Back Entry
- 50 USG Conv Gas Hot Water Tank
- Utility Passage Door-Open Above (No Grill).
- HRV System with Upgraded North Zone Sliders T/O
- 22"x36" with Venetian in Glass, Cottage Door in Dining Room, 2-30"x60" Windows in Living Room

Thomas Homes & R.V. Center

Box 7020 9900-78ST Peace River, AB

www.thomashomesandriv.com PH# 780-624-2720

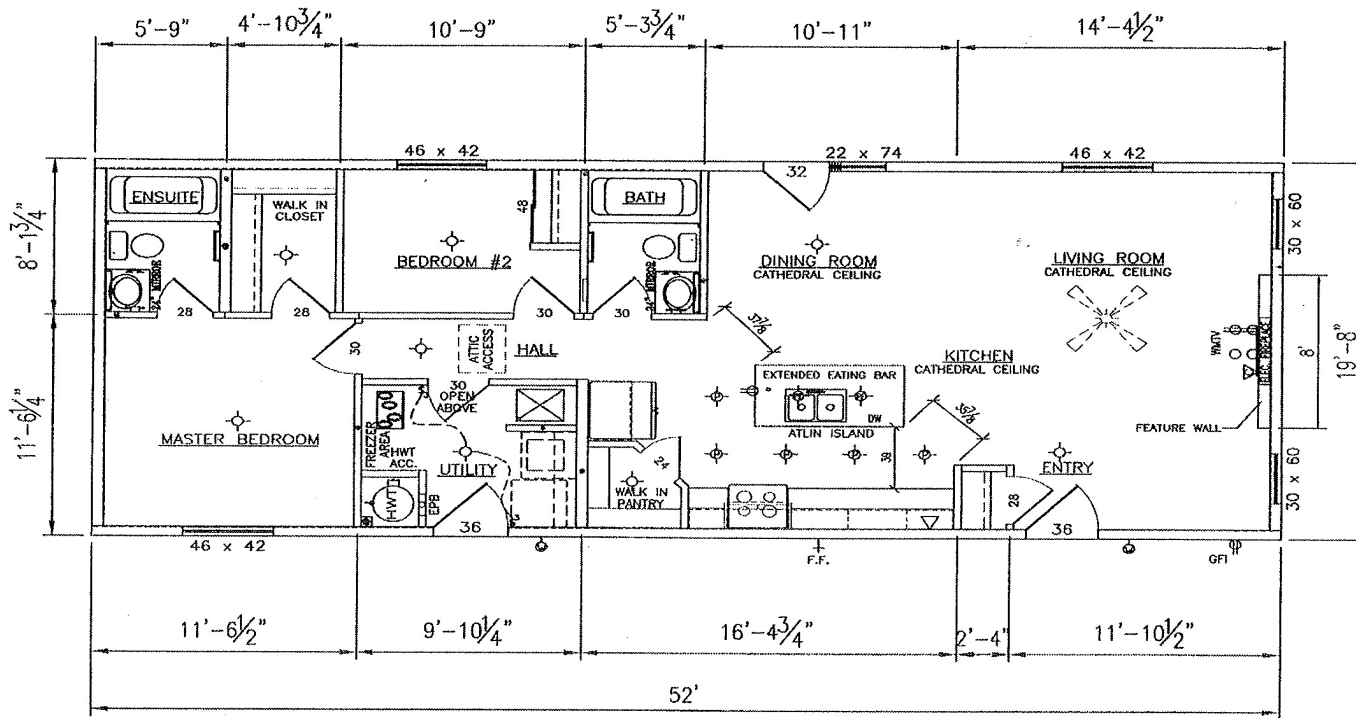

Show Home #2 CJS 3009

2022 20x52 1040 Sq. Ft 2 Bed/2 Bath

